

Deflection pulleys out of ETN - polyamide 6G

For inquiries fill the below in and send back to us

(Fax: +49-911-518474-24)

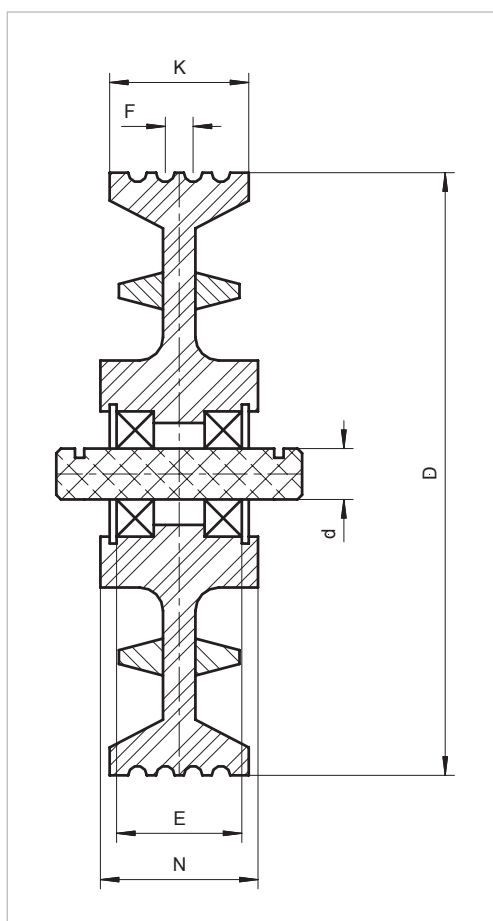

D) Diameter exterior	
K) Ring width	
E) Distance between the ball bearings	
N) Hubbroad width	
F) Distance of groove	
d) Diameter of the axle	
Diameter of the ropes	
Numbers of ropes	
Axle load	
Ball bearings	
Rope speed	
Units required	

Sender:

In addition to the driving wheel, various sizes, types and quantities of deflection rollers are used in rope elevators. It is absolutely possible to produce deflection rollers out of cast polyamide.

They offer the following important advantages:

- ▶ **particular for future replacement in already existing constructions.**
- ▶ **lower centrifugal mass, lower noises**
- ▶ **vibration is reduced by the material's excellent elastic properties**
- ▶ **the wear behaviour is at least equal to that of traditional grey cast iron rollers**